



Project:
DieZ Arena, gym, Diez, Germany

Building year: 2018

Installer:
Thom Glasbau

Product:
PC 2560-12 Color
crystal, opal and titanium grey

Application:
Façade light band

Quantity:
approx. 650 m²





Project:
Training centre of HC Davos,
Switzerland

Building year: 2018

Photographs: © Neomat AG

Product:
PC 2560-12 DuoColor
Heatbloc S / opal 067

Application:
Façade

Quantity:
approx. 2,200 m²

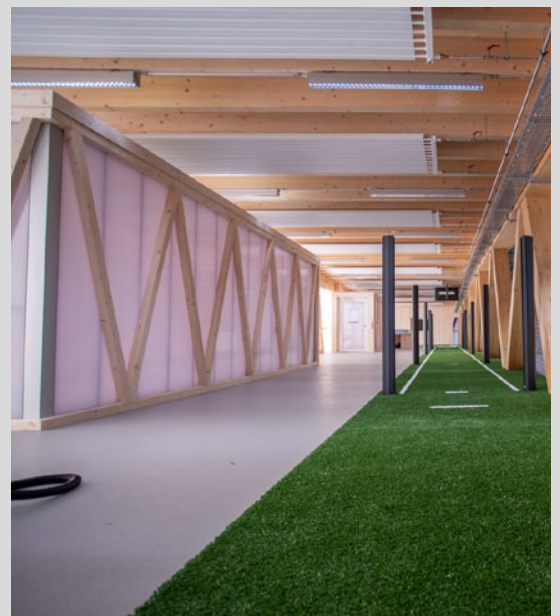



Project:
Founder laboratory Würzburg

Building year: 2018

Installer:
Hans Börner GmbH & Co KG

Photographs:
© Hans Börner GmbH & Co KG

Product:
PC 2560-12 crystal

Application: Façade

Special feature:
Printed façadepanels

Quantity: 440 m²

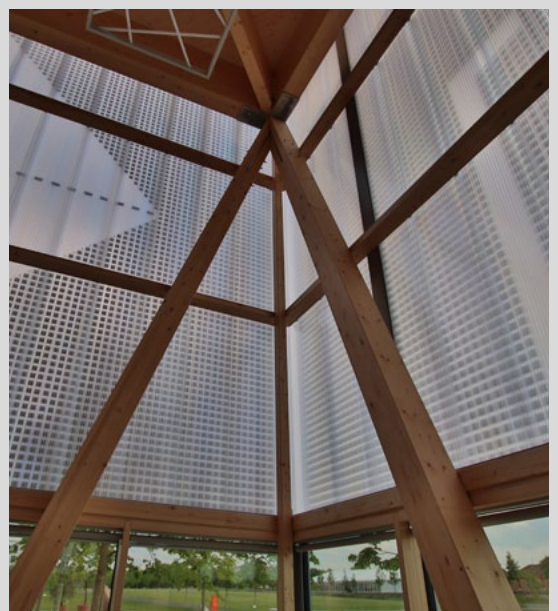



Project: Private school KW (Karol Wojtila) in Seseña, Spain

Building year: 2017

Architect: TRAZA ARQUITECTURA
Francisco F. Muñoz Carabias

Installer: Sumplastecnic

Photographs: © Traza Arquitectura

Product: PC 2540-10 crystal
PC 2560-12 crystal

Application: double façade
(combination of 40 + 60 mm LBE)

Quantity: approx. 2,050 m²



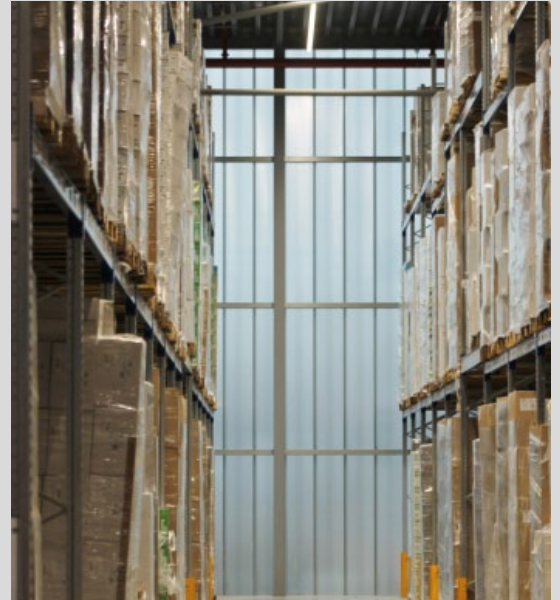

Project:
Extension of a storage and logistics
centre, Gude GmbH, Oberhausen

Building year: 2016

Architect: Planungsgruppe Mesum,
Wilhelm Bökenkamp

Product: PC 2550-10 DuoColor
Titane grey - crystal

Application: Façade

Special feature:
Colour adaption to the company
colour of Gude GmbH

Quantity: 1,780 m²

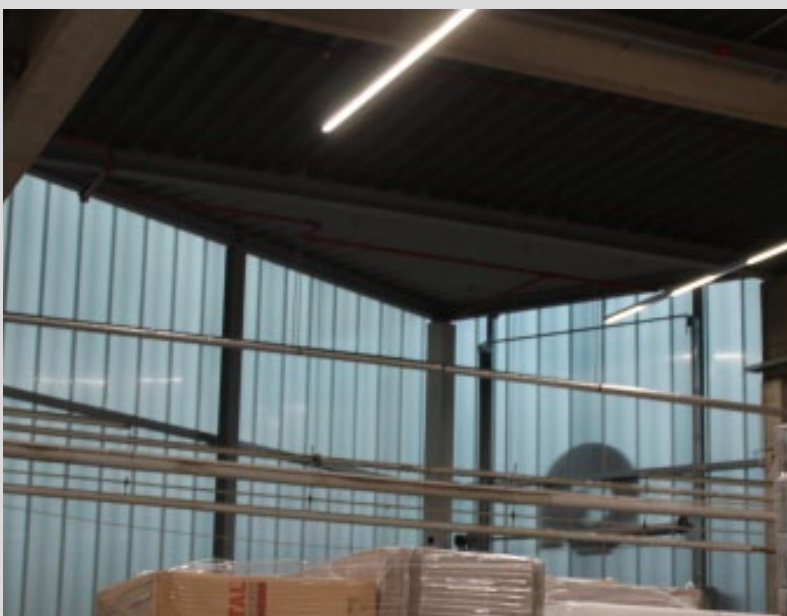



Project:
Elementary school De Diamant,
Apeldoorn, Netherlands

Building year: 2016

Architects: MTB Architecten

Photographs:
© MTB Architects

Product:
PC 2560-12 crystal

Application:
Façade, double wall glazing

Quantity: approx. 547 m²





Project: Restaurant Zoet of Zout,
Stellendam, Netherlands

Building year: 2015

Architects: HDK Architecten
Rotterdam

Photographs:
© Rodeca Systems b.v.

Product: PC 2560-12 DuoColor
petrol - opal

Application: Façade

Quantity: approx. 835 m²

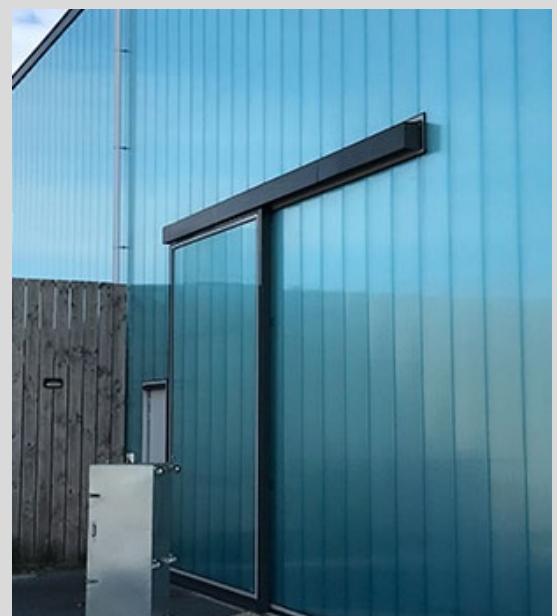



Project:
Front cladding of the sixth form block
of Graveney School in London, UK

Building year: 2014

Architects:
Urban Projects bureau Ltd.

Product:
PC 2560-12 crystal

Application:
Rainscreen cladding

Special feature:
Double façade construction

Quantity: approx. 1,300 m²





Project:
Multipurpose hall Mount St. Joseph
school, Milperra, Australia

Building year: 2014

Architects:
Young + Metcalf Architects
Suters Architects

Photographer: © Simon Wood

Product:
PC 2560-12 opal

Application:
Façade lightband

